

GENERATOR INTERCONNECTION APPLICATION

FOR ALL INVERTER BASED PROJECTS WITH AGGREGATE GENERATOR OUTPUT 20 kW OR LESS

Also Serves as Application for Category 1 Net Metering

Electric Utility Contact Information

Indiana Michigan Power
Interconnection Coordinator - Lesley Odom
PO Box 60
Fort Wayne IN 46801-0060
Interconnection Hotline: 260-408-3402
Interconnection Email: lkodom@aep.com

For office use only

Application No. _____

Date & Time Application Received

Customer / Account Information

Electric Utility Customer Information: (As shown on utility bill)

Customer Name (Last, First, Middle):

Customer Mailing Address:

Customer Phone Number:

Customer E-Mail Address: (optional)

Electric Service Account #

Electric Service Meter Number:

Are you applying for the Net Metering Program? Yes No

Are you interested in selling Renewable Energy Credits (REC's)? Yes No

Will you have an Alternative Electric Supplier? Yes No

Name:

Notes: Enter name ONLY if your energy is supplied by a 3rd party, not the utility.

You must apply to both the Distribution Utility and your Alternate Energy Provider (if applicable) for Net Metering

Generation System Site Information

Physical Site Service Address (if not Billing Address):

Annual Site Requirements Without Generation in Kilowatt-hours

Peak Annual Site Demand in Kilowatts (only for customers billed on demand rates)

Attached Site Plan:

Attached Electrical One-Line Drawing:

--

	kWh/year
	Kw

Page # --
Page # --

GENERATOR INTERCONNECTION APPLICATION

FOR ALL INVERTER BASED PROJECTS WITH AGGREGATE GENERATOR OUTPUT 20 kW OR LESS

Also serves as application for category 1 Net Metering

Generation System - Manufacturer Information

System Type (Solar, Wind, Biomass, Fuel Cell, etc.):
Generator Type (Inverter):
Total Generator Nameplate DC Rating (Solar Only):
Total Generator Nameplate AC Rating:
Generator AC Output Voltage:
Generator Wiring Configuration (Single Phase, Three Phase):
Expected Annual Output in Kilowatt-hours
Is the Inverter tested to IEEE1547.1?

	kW
	kW
	V
	kWh/year

Yes No

Inverter Based Systems:

Manufacturer
Model (Name / Number)
Inverter Output Power Rating (kW)
No. of Inverter(s)

	kW

Installation Information

Project Single Point of Contact: (Electric Utility Customer, Developer, or other)

Name:
Company (If Applicable):
Phone Number:
E-Mail Address:

Requested In Service Date:

--

Contractor (Name of Firm or Self):

Contractor Name (Last, First, MI):
Contractor Phone #:
Contractor E-Mail:

Customer and Contractor Signature and Fees

- Attached \$75 Interconnection Application Fee or
 Attached \$100 combined Interconnection & Net Metering Program application fees
(\$75 Interconnection Application Fee plus \$25 fee required if selecting net metering)

(Check # / Money Order #)

--

(Sign and Return complete application with Application Fee to Electric Utility Contact)
To the best of my knowledge, all the information provided in this Application Form is complete and correct.

Customer Signature

Contractor Signature (if applicable)

Note: Refer to the applicable "Michigan Electric Utility Generator Interconnection Procedures" for a detailed explanation of the Interconnection Process and Technical Requirements.

Sample Site Plan - Provided for Reference Only

Customer Name:	
Customer Address:	
Site Plan Prepared By:	
Date:	

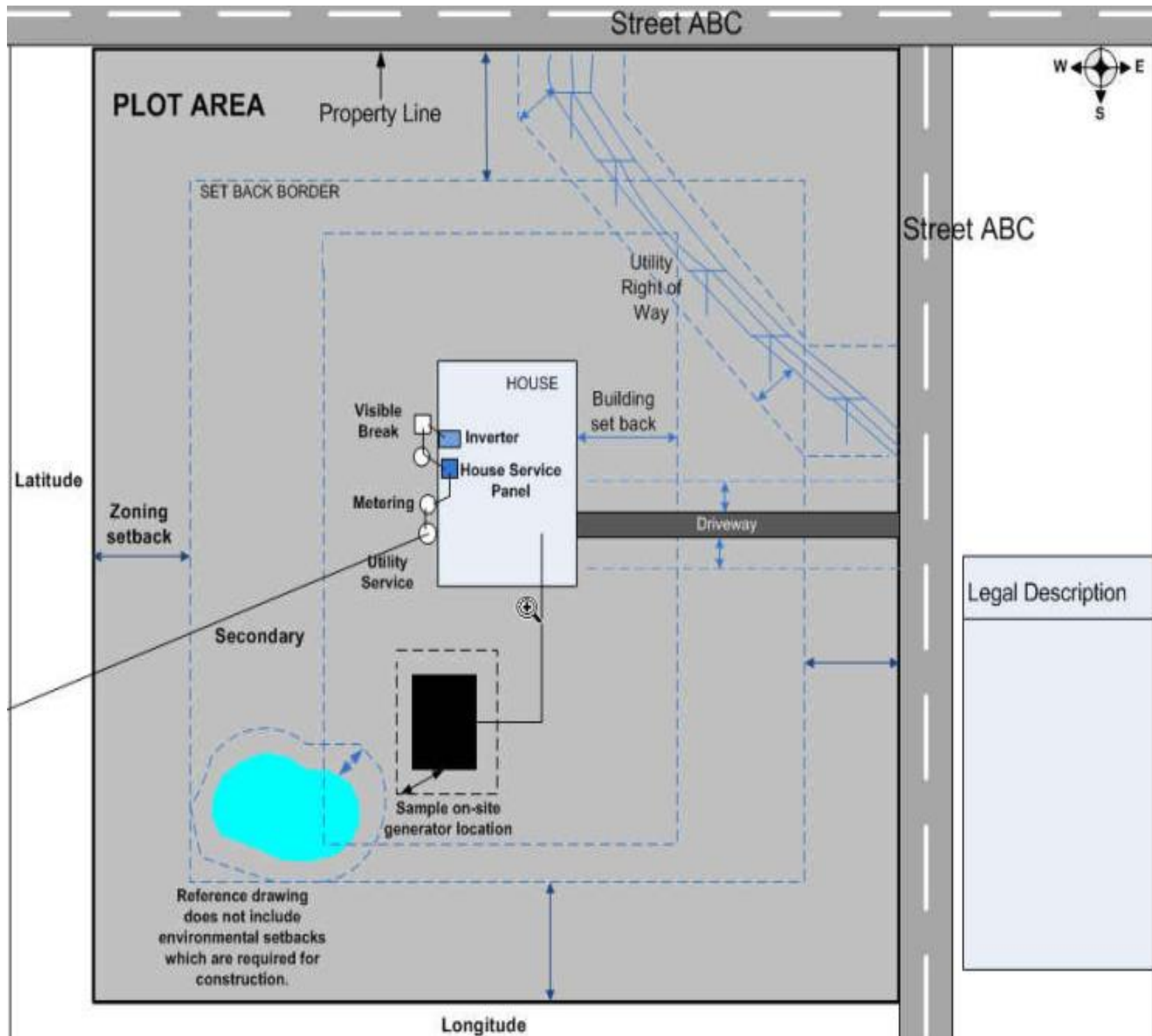

Note: Legible hand drawn site plans are acceptable

SAMPLE ONE-LINE DRAWING FOR NET METERING CATEGORY 1 PROJECTS

Note: Hand drawn One - Line Drawings are acceptable

Customer Name:	
Customer Address:	
Site Plan Prepared By:	
Date:	

